

Pressure regulator (103)

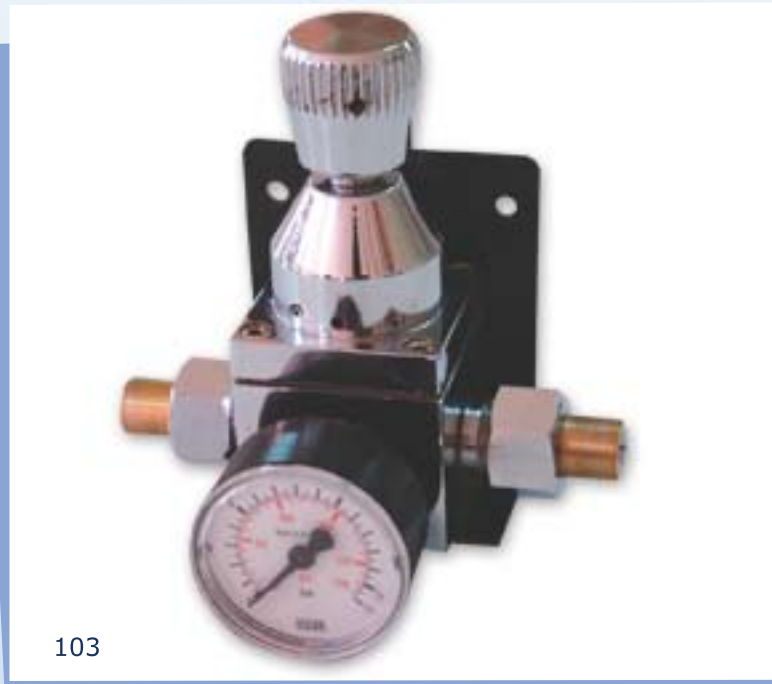

103

- 1- Manufactured from brass with the ability of decreasing the inlet pressure from 12 bar to 600m bar
- 2- outlet pressure gauge (From 0 to 16 bar)
- 3- Fixed plate
- 4- Valve for measuring the wanted Outlet pressure.

103-1	Oxygen regulator
103-6	Nitrous oxide regulator
103-5	Air regulator
103-4	Co2 regulator
103-3	Nitrogen regulator
103-2	Argon regulator

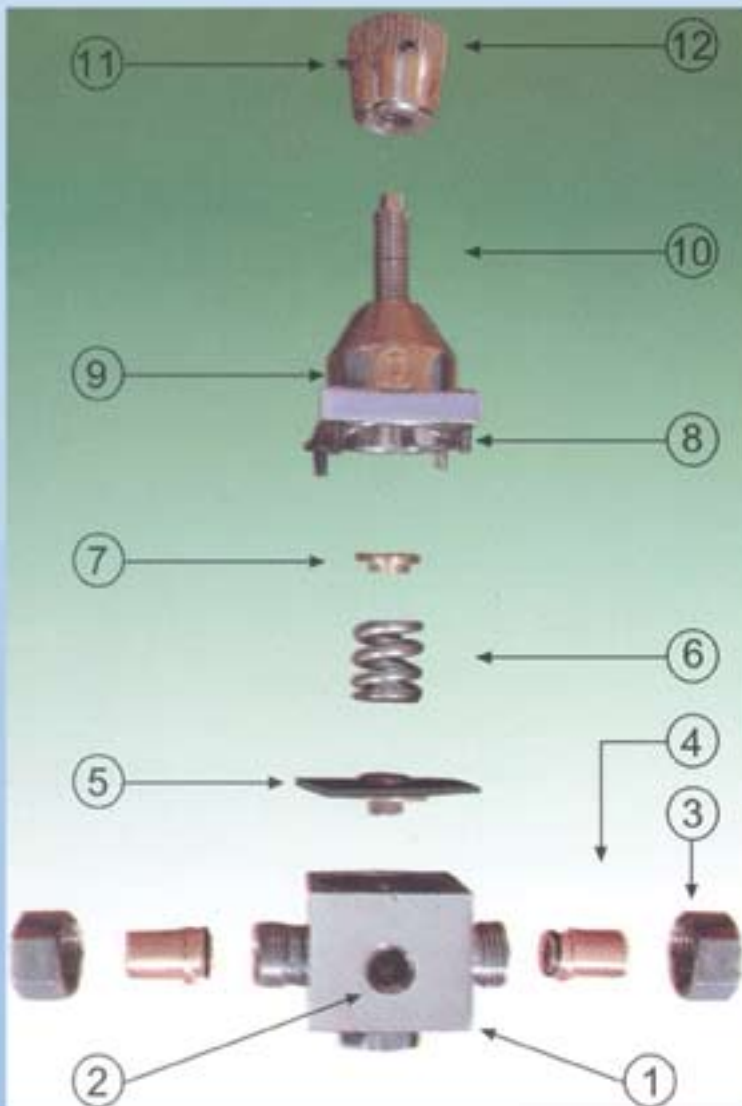

1	Regulator Body
2	Gauge place
3	Connection nut
4	Connection nibble
5	O-ring
6	Spring
7	Plate
8	Body Screw
9	High Body for regulator
10	Pressure valve
11	Pressure valve screw
12	Pressure measuring valve