

The medical gas outlet is the wall source for medical gases.
And it's the end of the medical piping system on the wall.



Description

- Outlet kind : Oxygen-nitrous oxide- Air (4bar) -Air (7bar) -vacuum ... etc
- Flow rate: 160L/min
- Work pressure: from 3-8 bar to 4.2 bar
- Maximum work pressure : double of work pressure.
- The outlet Designed: French standard and available for Surface mounting

102-1	Oxygen out let	102-4	N2O Out let
102-2	Vacuum out let	102-5	Air (7 bar)
102-3	Air (4 bar)	102-6	Nitrogen out let



Outlet : technical view

- 1.Fixed Nut : manufactured From brass Plated from Nickel Krum and it` s function is collect- ing all parts of outlet.
2. Cover : manufactured From (Aluminum or Plastic) and Have sticker which mention the kind and the color of the gas.
- 3.Box : manufactured from Plastic and the main Purpose from it is Protecting all Parts of the outlet.
4. Fixed Nut : manufactured from brass. It`s function is collecting the Socket Part and the First part.
5. The Socket: manufactured from brass:
 - the second valve which contact with the prop
 - the socket is Difference From gas to another
6. chaise : manufactured from stainless steel .main Purpose is Fixing all the outlet on the wall
- 7.The First : manufactured from brass and it's function is working As a main valve for the outlet when there is any Emergency case.

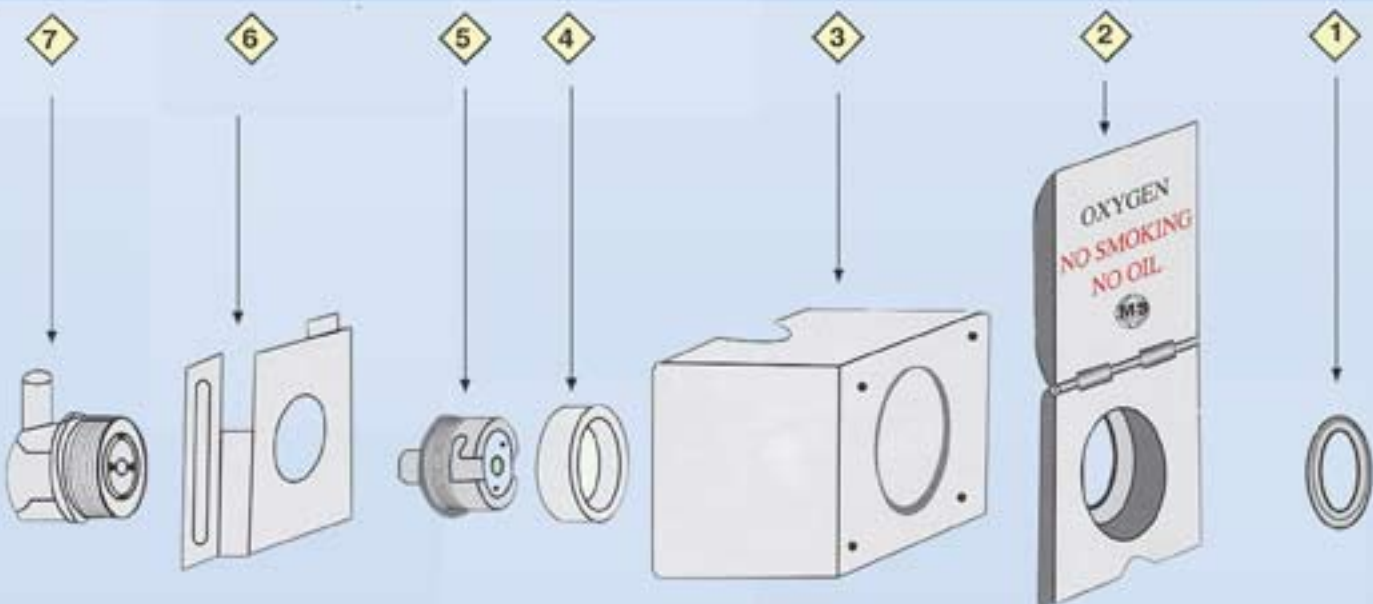

Socket valve : Technical view

5-1 O-ring : manufactured from silicon and the main purpose of it is prevent leakage between the outlet and the prop .

5-2 Body : manufactured from brass plated from nickel Krum it work as a Pass for collecting all parts of the socket valve .

5-3 O-ring : Silicon ring prevent leakage between the outlet collecting body and socket valve.

5-4 O-ring : Silicon ring : Prevent leakage in the socket valve area.

5-5 Socket valve : manufactured from brass plated with Nickel Krum work as a pusher for the spring in the socket body.

5-6 Filter : Stain lees steal filter and it be inside the socket valve

5-7 spring : manufactured from plated steal

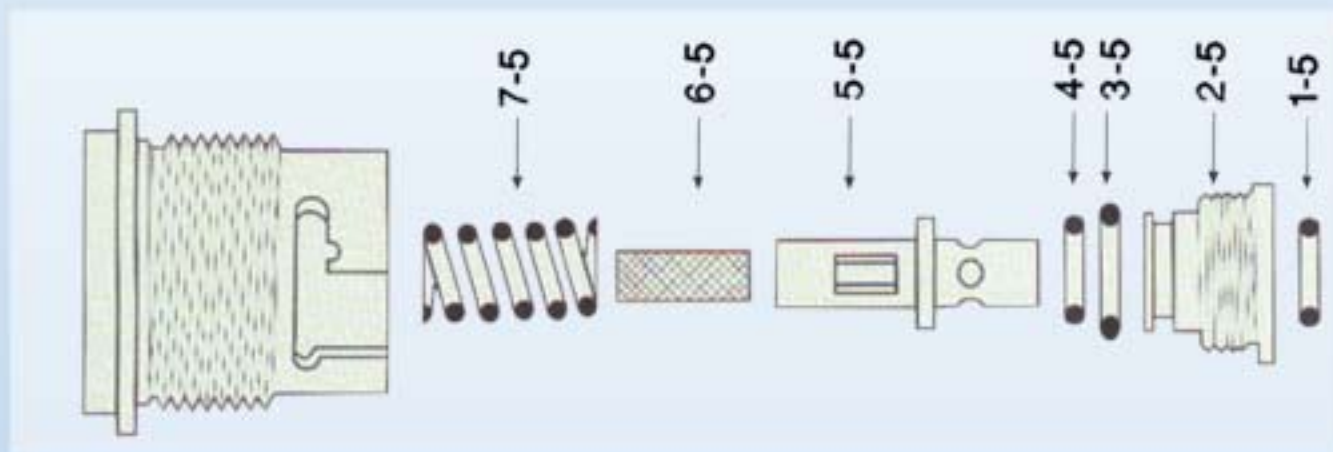

First valve : Technical view

7-1 Body : manufactured from brass main purpose is to collect all part of first valve.

7-2 O-ring : Silicon ring to prevent leakage between first valve body and all internal parts of it.

7-3 O-ring : Silicon ring to prevent gas leakage between the pusher and the end of the valve .

7-4 First pusher : manufactured from brass plated with nickel Krum work as a pusher for the spring into the first valve body .

7-5 Spring : manufactured from plated steal

7-6 Connecting pipe: manufactured from brass to connect the outlet with piping system.

