

MS Medical Flow meter is used to adjust and measure the wanted flow of gas for patient .



The flow meter should be connected to a source of pressured gas on the wall using direct probe or rail system.

The oxygen flow meter must be fitted with humidifier or an outlet tubing apple combined with an Oxygen mask or Cannula.

- Chromium-plated brass body (high shock resistant)
- Polycarbonate reading scale and scale cover
- Flow rate available: 0-15L/min
- Filter at the scale inlet: patient and flow meter protection
- Knob: Easy to maintain, offers optimum adjustment quality

- Available with French, BS and DIN standard
- Identification ring allows immediate identification and also indicates the name of the gas

FLOW METER - TECHNICAL VIEW

1	Inlet connector
2	Body
3	Inlet gasket for flow meter
4	Humidifier or nipple connector
5	knob 5-a gasket for the end of the knob 5-b outer gasket of the knob 5-c knob hand wheel 5-d color disk White o2 disk- black air disk
6	Identification ring White o2 ring Black air ring
7	Flow meter filter
8	O-ring for scale cover
9	Complot scale set 9-a scale bottom stopper 9-b scale 9-c scale top stopper
10	Polycarbonate scale cover

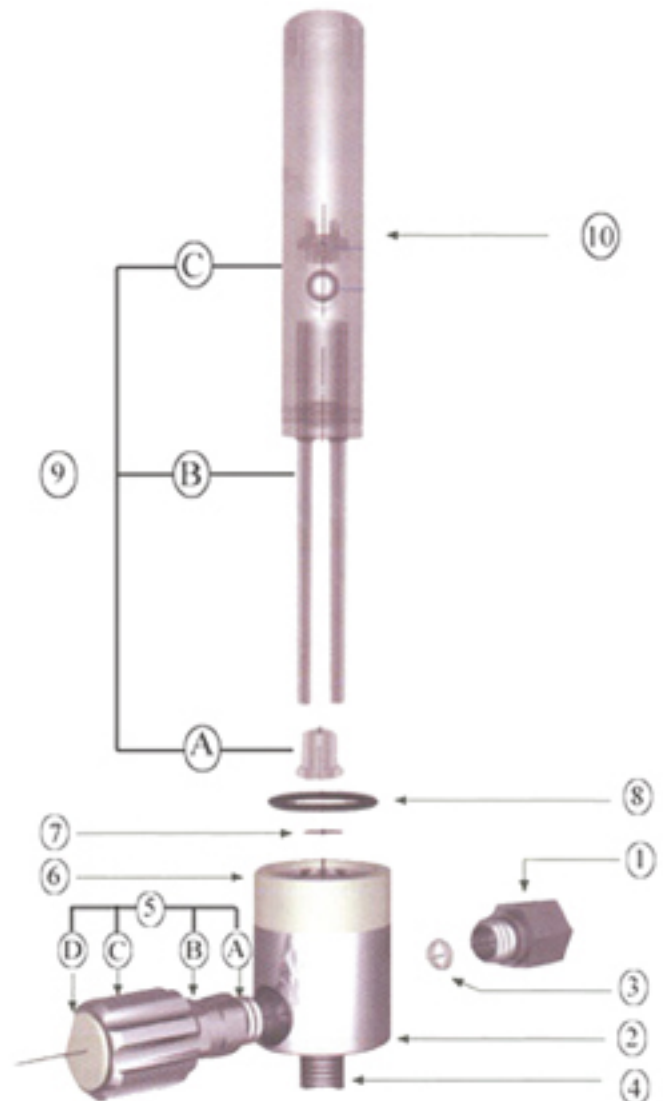

NEW ALUMINUM MS FLOW METER



90901902

- Aluminum body (high shock resistant)
- Flow rate available: 0-15L/min
- Available with French, BS & DIN standard

NEW DOUBLE MS FLOW



90901903

- Available with French, BS and DIN standard